



### KEY FEATURES

- Electrical rotary indexing table with 6 stations (optional with 4)
- Safety enclosure of the working area with two hand buttons
- With pneumatic ejection of the riveted parts on request

### PROCESS CONTROL

**HPP-25:** Process monitoring with integrated riveting controller  
or  
**RC-30:** Control unit by time setting

#### HPP-25

- 5,7" Touchscreen LED-backlit
- Process data are continuously evaluated and stored
- Integrated riveting curve visualization for a simple process analysis
- USB- and Ethernet interfaces and integrated data logger
- Graphical display of riveting force- and deformation path-curve
- Indicator on riveting head home position and lower endposition
- Status display in-/output of the riveting curve

#### RC-30

- 4.3" Touchscreen, LED-backlit
- Control Software on SD card – SW updates via SD card possible
- Total hardware in semiconductor technology executed
- All connections on the back side conducted by plugs
- Housing in sheet metal construction, IP 53
- Stroke counter and hour counter – resettable
- Total stroke counter and hour counter – not resettable

**MAIN DIMENSIONS AND WEIGHTS**

Model	kN	H	K	R	I	L	N	O	P	Q	kg
RNR 081	08.-2.4	2-25	644	644	676-773	264	75	205	95-129	419	70
RNR 181	1.8-6.6	5-30	1027	690	809-959	261	102	225	35-185	549	95
RNR 181H	1.2-3.6	5-30	1027	690	809-959	261	102	225	35-185	549	95
RNR 181R	0.2-1.5	5-30	1027	690	809-959	261	102	225	35-185	549	95
RNR 231	3.8-12	5-40	1027	660	829-979	270	110	225	6-156	549	110
RNR 281	5.8-17	5-40	1085	748	918-1068	291	125	235	24-174	559	195
RNR 281R	3.0-9.5	5-40	1085	748	918-1068	291	125	235	24-174	559	195

Further dimensions: please ask for our detailed dimensional drawings.

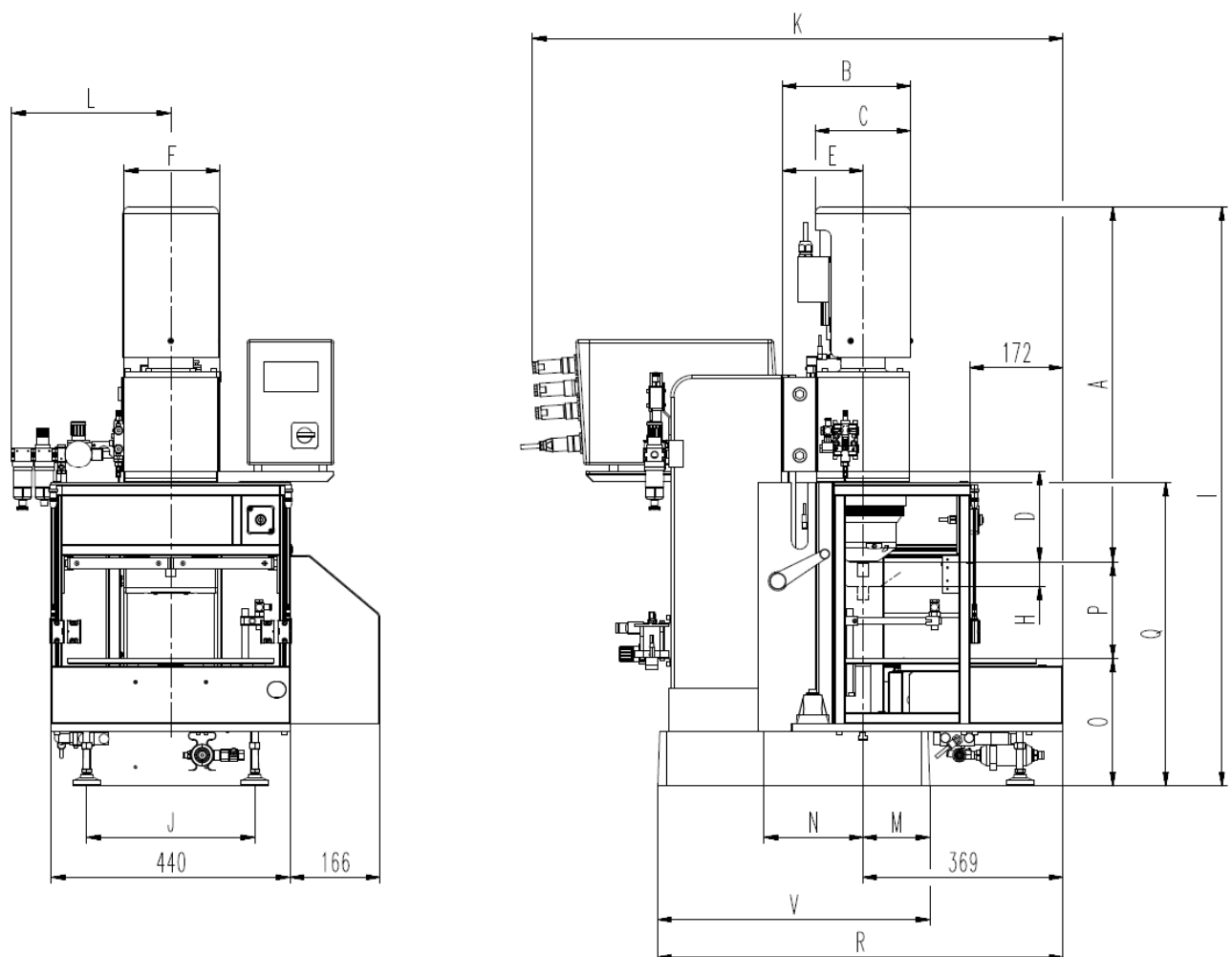

Subject to technical changes